

Open Space

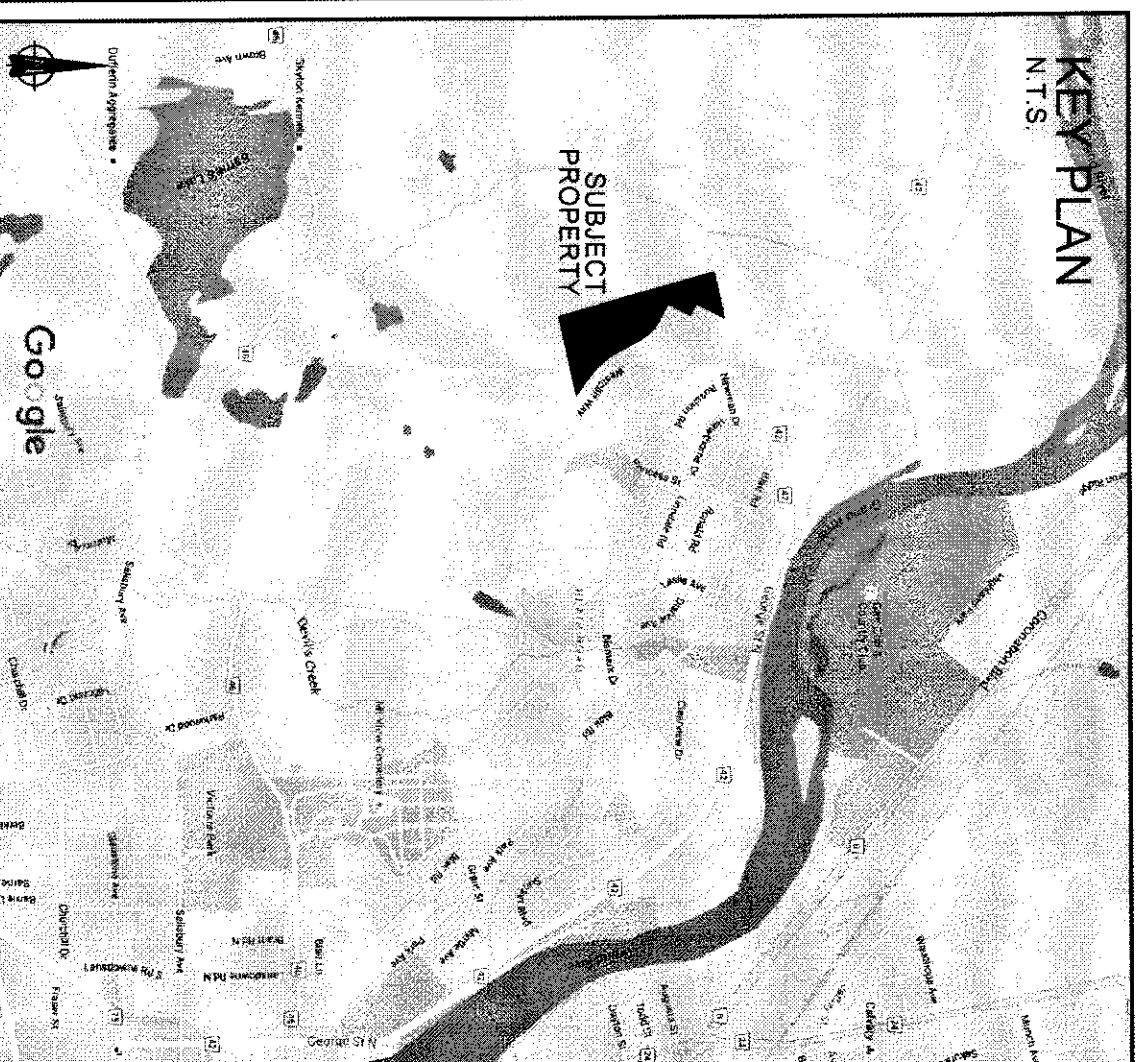

KEY PLAN
N.T.S.

LAND USE SCHEDULE

DESCRIPTION	LOTS/BLOCKS	UNITS	AREA (ha.)
Single Detached Residential	1-90	90	4.48
Park	91		0.36
Stormwater Management	92		1.66
0.3m Reserve	93		0.00
Roads			1.80
Total		90	8.30

ADDITIONAL INFORMATION

(UNDER SECTION 51(17) OF THE PLANNING ACT)
 INFORMATION REQUIRED BY CLAUSES 8(d) & (g) and 1 ARE AS SHOWN ON DRAFT PLAN.
 i) Municipal water supply
 ii) Sandy clay loam, sand & gravel
 iii) All sanitary and storm sewers as required

OWNER'S CERTIFICATE

I AUTHORIZE THE GSP GROUP INC. TO PREPARE AND SUBMIT THIS DRAFT PLAN OF SUBDIVISION TO THE REGIONAL MUNICIPALITY OF WATERLOO.

OWNER: Huron Crest Developments DATE: October 26, 2016

SURVEYOR'S CERTIFICATE

I CERTIFY THAT THE EQUIPMENTS OF THE LAND TO BE SUBDIVIDED AND THEIR RELATIONSHIP TO THE ADJACENT LANDS ARE CORRECTLY SHOWN.

ROD LODI O.L.S. DATE: October 26, 2016
 MacDonald Land Surveying Limited

DRAFT PLAN OF SUBDIVISION

Part of Lot 2, Concession 102
 West of the Grand River
 (Formerly in the City of Galt)
 City of Cambridge
 Regional Municipality of Waterloo



PLANNING URBAN DESIGN LANDSCAPE ARCHITECTURE	Drawn By: S. Longman	Project No.: 16104.40
Date August 22, 2016	Dwg File Name: 4016104.dwg	
Scale: 1:1000 metric		

REVISIONS