

ROAD CENTERLINE ELEVATIONS	PRE DEVELOPED GROUND ELEVATIONS	ROAD CENTERLINE ELEVATIONS	PRE DEVELOPED GROUND ELEVATIONS
309.385	310.03	308.885	308.61
308.285	309.94	308.785	308.20
308.185	309.96	308.685	308.59
308.085	310.03	308.585	308.20
308.985	310.25	308.485	308.20
308.885	310.46	308.385	308.20
308.785	310.60	308.285	308.20
308.685	309.92	308.185	308.20
308.585	309.09	308.085	308.20
308.485	308.59	307.985	308.20
308.385	308.20	307.885	308.20
308.285	308.61	307.785	308.20

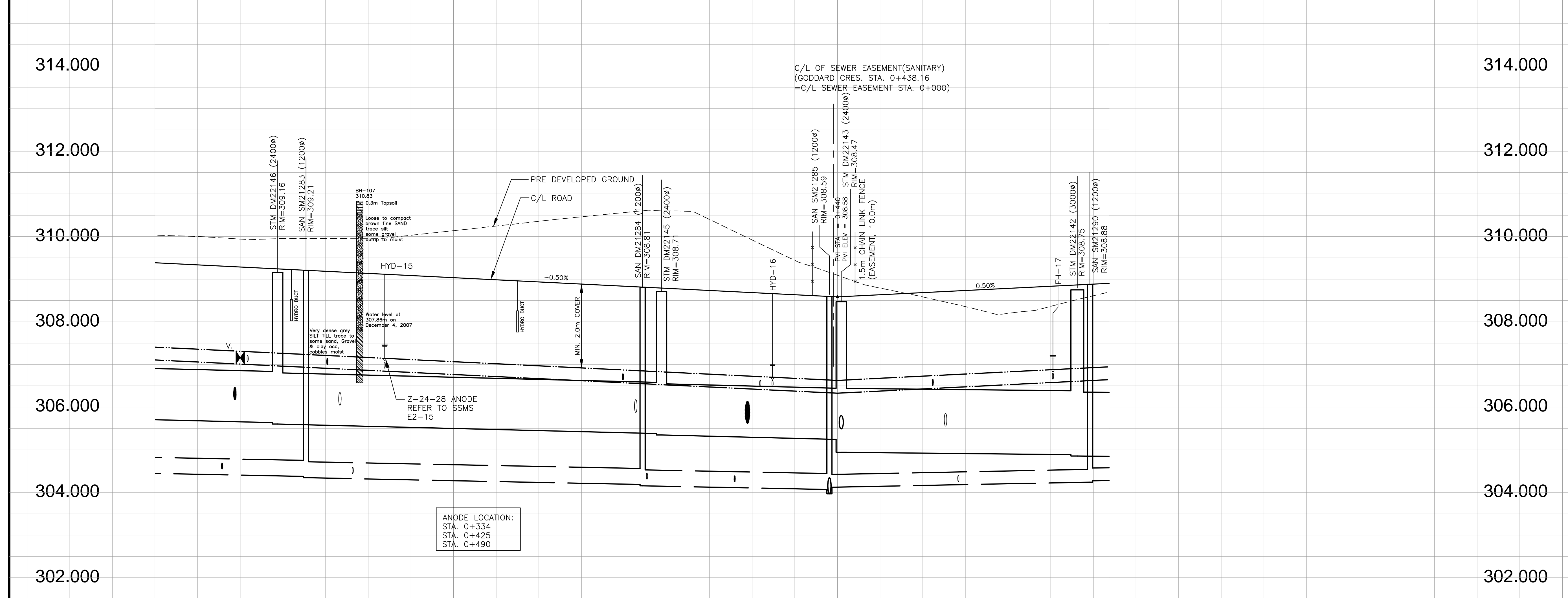

ANODE LOCATION:  
 STA. 0+334  
 STA. 0+425  
 STA. 0+490

TOP OF WATERMAIN	STORM INVERTS	SANITARY INVERTS	CHAINAGE	TOP OF WATERMAIN	STORM INVERTS	SANITARY INVERTS	CHAINAGE
303.00m OF 300mmØ DR-18 PVC WATERMAIN @ 0.49% GRADE	88.20m OF 1200mmØ 65-D CONC. STM SEWER @ 0.28% GRADE	90.92m OF 375mmØ SDR-35 PVC SAN SEWER @ 0.23% GRADE	0+280	140.0m OF 300mmØ DR-18 PVC WATERMAIN @ 0.50% GRADE	90.92m OF 1200mmØ 65-D CONC. STM SEWER @ 0.25% GRADE	79.19m OF 375mmØ SDR-35 PVC SAN SEWER @ 0.28% GRADE	0+340
			0+300		43.19m OF 1200mmØ 65-D CONC. STM SEWER @ 0.25% GRADE	43.33m OF 375mmØ SDR-35 PVC SAN SEWER @ 0.20% GRADE	0+360
			0+320		57.64m OF 1500mmØ 65-D CONC. STM SEWER @ 0.10% GRADE	61.35m OF 300mmØ SDR-35 PVC SAN SEWER @ 0.31% GRADE	0+380
			0+340				0+400
			0+360				0+420
			0+380				0+440
			0+400				0+460
			0+420				0+480
			0+440				0+500

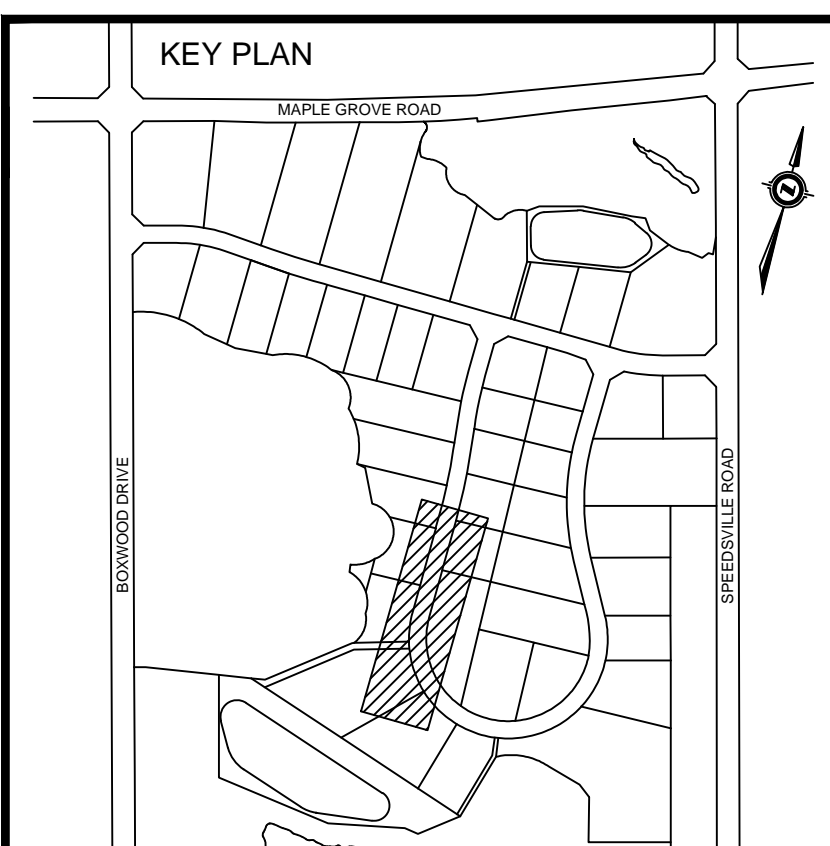

**BENCHMARKS**  
 RMW317: ELVE. 306.269  
 TABLE IN FOUNDATION OF WHITE BRICK PORTION OF FORMER MAPLE GROVE SCHOOL ON MAPLE GROVE ROAD AT SPEEDVILLE ROAD. TABLE IS IN SOUTH SIDE OF BUILDING 0.10M WEST OF SOUTH EAST CORNER OF BUILDING AND 0.20 M ABOVE GRADE.  
 RMW319: ELVE. 310.607  
 TABLE IN SOUTH FACE OF CONCRETE BASE FOR SIGNAL CONTROL BOX AT NORTH EAST CORNER OF MAPLE GROVE ROAD AND FOUNTAIN STREET. TABLE IS 0.10 M EAST OF SOUTH WEST CORNER OF BASE.  
 RMW320: ELVE. 306.619  
 TABLE IN WEST END OF RETAINING WALL IN ENTRANCE WAY TO WATERLOO REGIONAL POLICE HEADQUARTERS AND REGIONAL OPERATIONS CENTRE. RETAINING WALL IS LOCATED WHERE DRIVEWAY SPLITS TO RESPECTIVE BUILDINGS. TABLE IS LOCATED 0.3 M ABOVE GRADE.  
 RMW322: ELVE. 309.767  
 ELEVATION IS FOR A BRONZE TABLE SET IN A RED BRICK BUILDING (REGIONAL AMBULANCE BUILDING) @ THE SOUTHEAST CORNER OF CHERRY BLOSSOM DRIVE AND FOUNTAIN STREET.  
 THE TABLE IS SET IN WEST WALL (IN BRICK) 0.15 M. NORTH OF THE SOUTH END OF BUILDING AND 0.15 M. ABOVE GRADE.

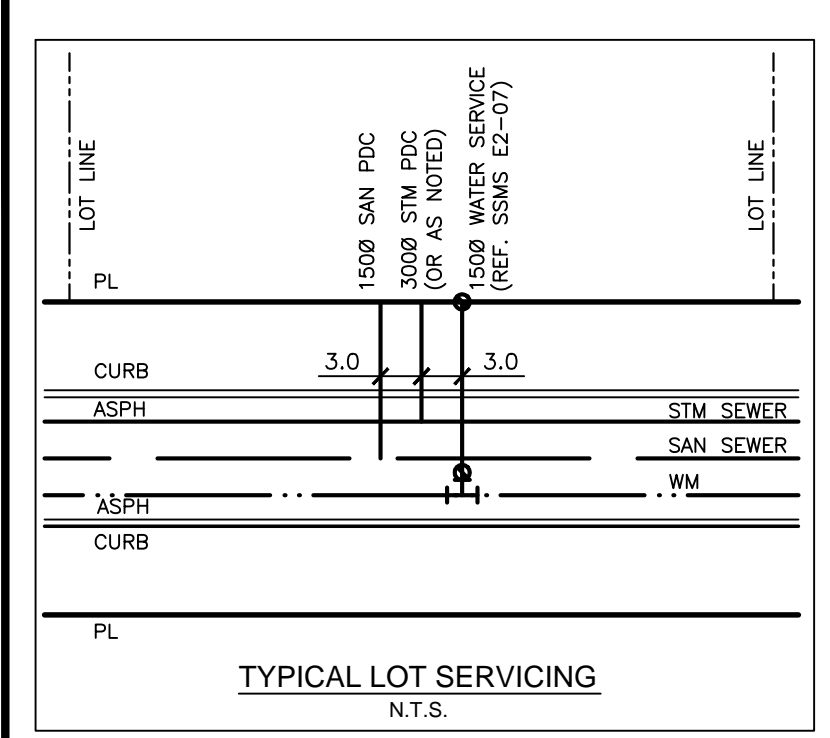

DRAWINGS TO BE READ IN CONJUNCTION WITH GEOTECHNICAL INVESTIGATION PREPARED BY CHUNG & VANDER DOELEN ENGINEERING LTD., FILE NO. 07-07-K20 SUB, DATED FEBRUARY 2, 2011.

THE PARCEL INFORMATION SHOWN ON THIS MAP IS COMPILED FROM VARIOUS SOURCES & IS NOT WARRANTED AS TO ITS ACCURACY BY THE MUNICIPALITY. USERS ARE REMINDED THAT LOT SIZES & LEGAL DESCRIPTIONS MUST BE CONFIRMED AT THE LAND REGISTRY OFFICE. THIS IS NOT A LEGAL DOCUMENT.  
 THE LOCATIONS OF EXISTING UNDERGROUND UTILITIES ARE SHOWN IN AN APPROXIMATE WAY ONLY AND HAVE NOT BEEN INDEPENDENTLY VERIFIED BY THE OWNER OR THE CITY'S REPRESENTATIVE. THE CONTRACTOR SHALL DETERMINE THE EXACT LOCATION OF ALL EXISTING UTILITIES PRIOR TO CONSTRUCTION AND IS RESPONSIBLE FOR ANY OR ALL DAMAGES WHICH MIGHT OCCUR BY THE CONTRACTOR'S FAILURE TO EXACTLY LOCATE AND PRESERVE ANY AND ALL UNDERGROUND UTILITIES.

NO.	REVISION	BY	DATE
	AS CONSTRUCTED	R.P.	02/19/14

TRUE

STAMP

SURVEY DATA:  
 SURVEY BY: R.N.  
 DATE: DECEMBER 2010  
 FIELD BOOK:  
 REQUISITION NO:  
 CHECKED BY:  
 DATE:

DRAWING INFORMATION:  
 DRAWN BY: R.P./J.U.  
 DATE: JANUARY 2012  
 DESIGN BY: R.A.  
 DATE: JANUARY 2012  
 CHECKED BY: K.H.  
 DATE: JANUARY 2012



**Delcan** 675 QUEEN STREET S.  
 SUITE 201  
 KITCHENER, ONTARIO, CANADA  
 N2M 1A1  
 TEL: (519) 744-4509  
 FAX: (519) 744-2822  
 WWW.DELCAN.COM

**BOXWOOD SUBDIVISION**  
 GODDARD CRES.  
 STA.0+280 TO STA.0+500

SCALE:  
 HORIZONTAL: 1:500  
 VERTICAL: 1:50

DRAWING NO:  
**PP-06**