

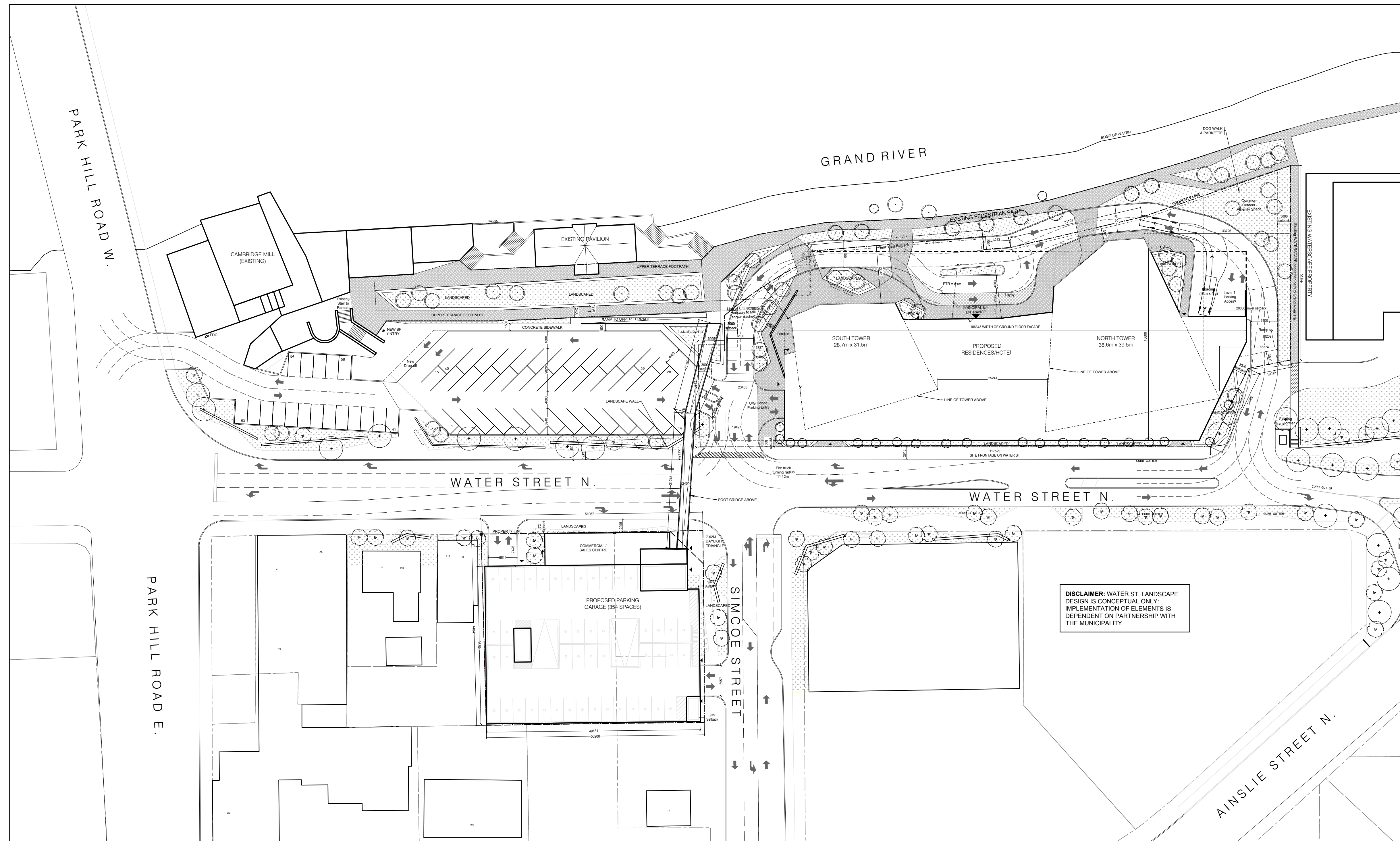

2 KEY PLAN
A100 SCALE: NTS



1 OVERALL SITE PLAN
A100 SCALE: 1:500

№	DATE	ISSUE
2	21-01-12	PRE-CONSULTATION
1	20/10/15	ZONING APPLICATION

MARTIN SIMMONS
ARCHITECTS

113 BREITHAUPT STREET, SUITE 200
KITCHENER, ONTARIO, N2H 5G9
TEL. 519-745-4754 FAX. 519-745-0061

DO NOT SCALE THESE DRAWINGS. THE CONTRACTOR SHALL VERIFY ALL DIMENSIONS AND REPORT ANY ERRORS AND/OR OMISSIONS TO THE ARCHITECT / CONSULTANT BEFORE COMMENCING THE WORK.
THESE DRAWINGS ARE THE PROPERTY OF THE ARCHITECT / CONSULTANT AND ARE NOT TO BE DUPLICATED OR DISTRIBUTED WITHOUT CONSENT FROM THE ARCHITECT / CONSULTANT.

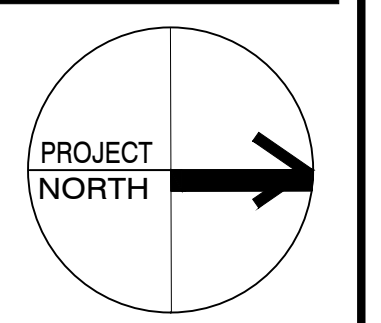

PROJECT
**CAMBRIDGE MILL
CONDO/HOTEL
130 WATER ST. N**
CAMBRIDGE, ONTARIO
DRAWING
OVERALL SITE PLAN

DRAWN BY: ML
CHECKED BY: JS
DATE: SEPT., 2020
SCALE: AS NOTED
DRAWING №: **A100**
PROJECT №: 19047-1