

EXTERIOR LUMINAIRE SCHEDULE						
TYPE	ACCEPTABLE MANUFACTURERS	MODELS	CATALOGUE NUMBERS	DESCRIPTION DIM. OF LAMPS VOLTAGE	LOCATION MOUNTING HEIGHT	NOTES
AA1	LITHONIA	WEDGE 1	WEDGE1.LED.P1.30K.80CRI.VF.MVOLT.SRM.DBLXLD	LED WALLPACK 3000K TOW 120V	EXTERIOR SURFACE 8' A.F.G	CONNECT TO TIME CLOCK CONTROLS.
AA2	LITHONIA	WEDGE 1	WEDGE1.LED.P1.30K.80CRI.VW.MVOLT.SRM.DBLXLD	LED WALLPACK 3000K TOW 120V	EXTERIOR SURFACE 8' A.F.G	CONNECT TO TIME CLOCK CONTROLS.
BB1	LITHONIA	LDN4	LDN4.3000K.05.L04.R.LSS.120.	4" LED POTLIGHT 3000K 6W 120V	EXTERIOR SURFACE CANOPY	CONNECT TO TIME CLOCK CONTROLS.
CC1	FC LIGHTING	FCW1500	FCW1500.120V.3K.CRI84.BKE.UNL.D3080/8L	LED WALLPACK 3000K 6W 120V	EXTERIOR SURFACE 8' A.F.G	CONNECT TO TIME CLOCK CONTROLS. OPTICS ROTATED 20 DEGREES TOWARDS THE WALL
DD1	LITHONIA	D-SERIES	DSXB.LED.12C.350.30K.ASY	LED BOLLARD 3000K 16W 120V	COURTYARD BOLLARD	CONNECT TO TIME CLOCK CONTROLS.

- SITE LIGHTING NOTES:**
- THIS DRAWING IS FOR FIXTURE LOCATIONS AND PHOTOMETRIC LAYOUT OF SITE LIGHTING ONLY. CONTACT ELECTRICAL CONSULTANT FOR BUILDING ELECTRICAL SITE PLAN TO CONFIRM LAYOUT OF CONDUIT ROUTING, CIRCUIT ARRANGEMENT, AND WIRE SIZING.
 - VOLTAGES OF FIXTURES ARE TO BE VERIFIED WITH THE ELECTRICAL SITE PLANS PRIOR TO ORDERING FIXTURES.
 - ELEVATIONS OF BASES ARE TO BE COORDINATED WITH SITE GRADING PLAN.
 - SUBSTITUTIONS OF LIGHT FIXTURES ARE NOT PERMITTED.
 - PHOTOMETRICS SHOWN CONSIDER ALL FACTORS AFFECTING LIGHT OUTPUT LEVELS SUCH AS LAMP AND BALLAST DEPRECIATION AND DIRT ACCUMULATION OVER AN ESTIMATED ONE-YEAR PERIOD.
 - PHOTOMETRIC VALUES ARE SHOWN IN FOOTCANDLES (fc). A LIGHT LOSS FACTOR OF 0.9 WAS USED IN THE CALCULATION.
 - ALL EXTERIOR LIGHTING MUST BE CONTROLLED BY PHOTOCELL, ASTRONOMICAL TIME CLOCK, OR A COMBINATION OF BOTH TO ENSURE THAT IT IS NOT 'ON' DURING TIMES WHEN SUFFICIENT DAYLIGHT IS AVAILABLE.

ELECTRICAL LEGEND

WALL MOUNTED LIGHT FIXTURE (z = TYPE AS PER SCHEDULE)

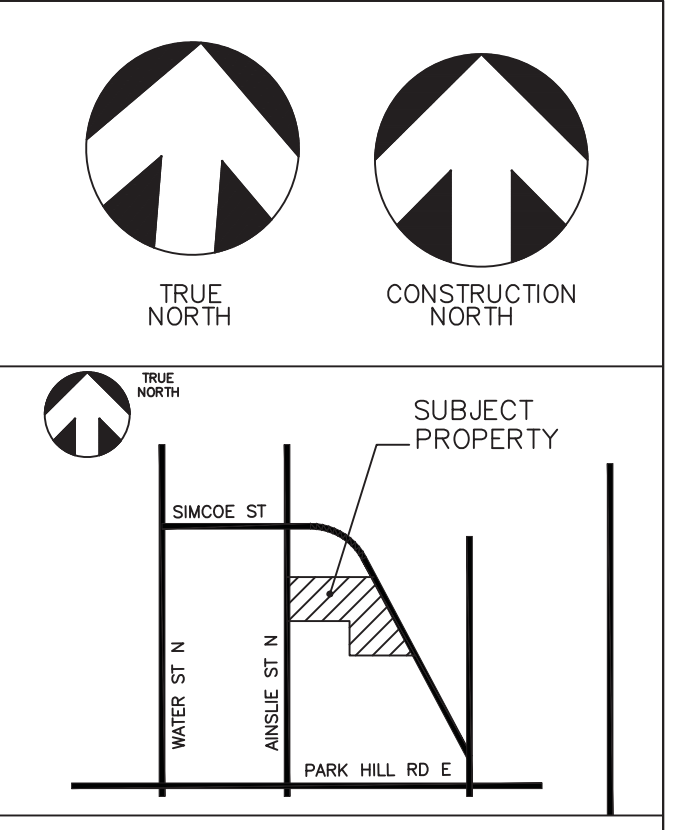
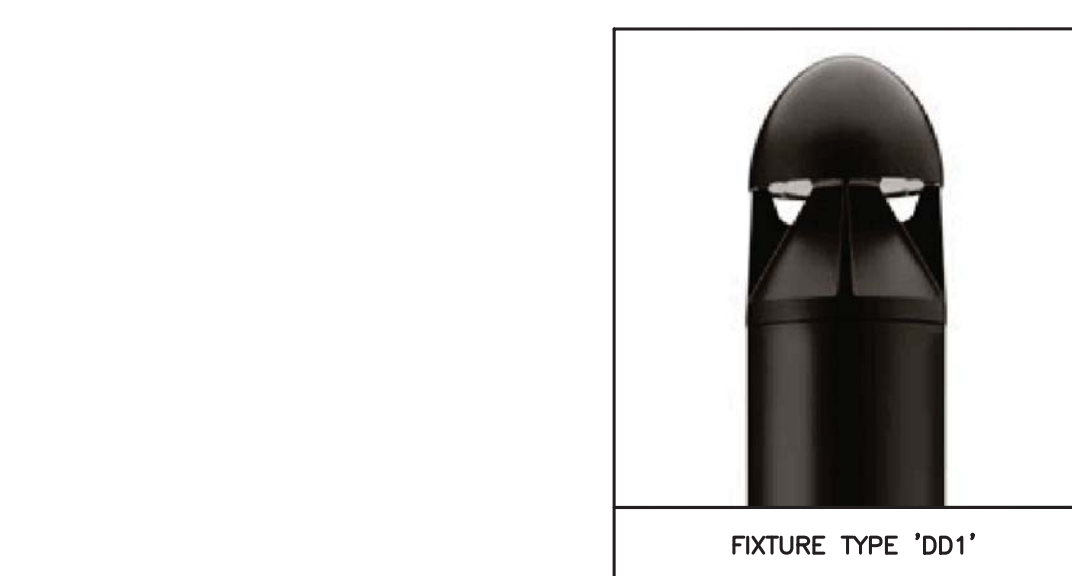
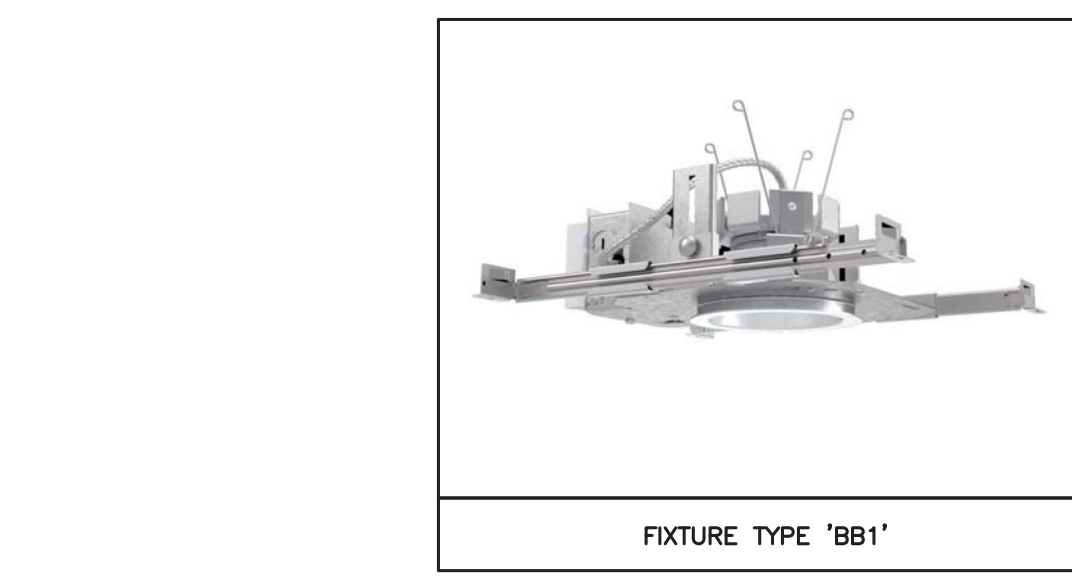
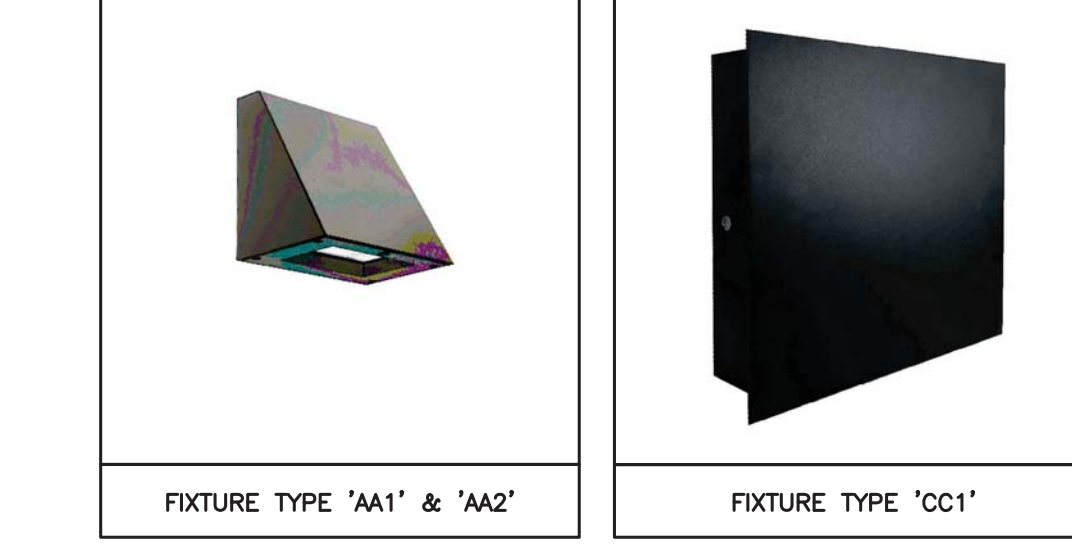

5		
4		
3		
2		
1	ISSUED FOR SPA	2022.03.22
No	REVISION	DATE

MIGHTON ENGINEERING
 300 VICTORIA ST N. 2ND FL. PH (519) 745-3703
 KITCHENER, ON FAX (519) 745-5081
 N2H 6R9 WEB www.mighton.com

PROJECT TITLE:
149 AINSLIE STREET N. APARTMENT
 149 AINSLIE STREET NORTH,
 CAMBRIDGE, ONTARIO

DRAWING TITLE:
SITE LIGHTING PLAN

DRAWN BY: J.L	CUSTOMER PROJECT No. ---
CHECKED BY: T.A	MIGHTON PROJECT No. 42205
DATE: MAR 2022	DRAWING No. ---
SCALE: AS NOTED	SL.1

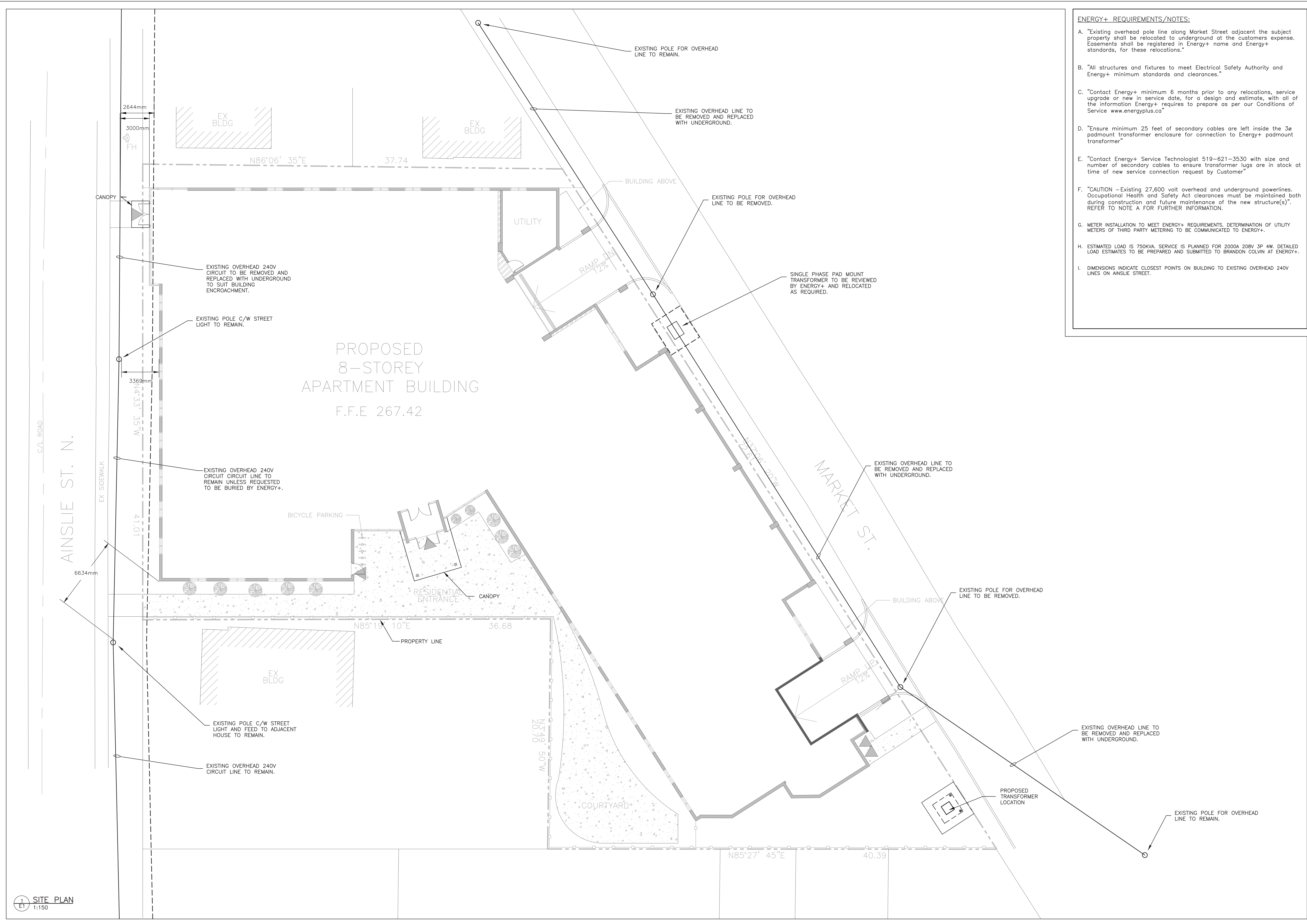

- ENERGY+ REQUIREMENTS/NOTES:**
- A. "Existing overhead pole line along Market Street adjacent the subject property shall be relocated to underground at the customers expense. Easements shall be registered in Energy+ name and Energy+ standards, for these relocations."
 - B. "All structures and fixtures to meet Electrical Safety Authority and Energy+ minimum standards and clearances."
 - C. "Contact Energy+ minimum 6 months prior to any relocations, service upgrade or new in service date, for a design and estimate, with all of the information Energy+ requires to prepare as per our Conditions of Service www.energyplus.ca"
 - D. "Ensure minimum 25 feet of secondary cables are left inside the 3ø padmount transformer enclosure for connection to Energy+ padmount transformer"
 - E. "Contact Energy+ Service Technologist 519-621-3530 with size and number of secondary cables to ensure transformer lugs are in stock at time of new service connection request by Customer"
 - F. "CAUTION - Existing 27,600 volt overhead and underground powerlines. Occupational Health and Safety Act clearances must be maintained both during construction and future maintenance of the new structure(s)". REFER TO NOTE A FOR FURTHER INFORMATION.
 - G. METER INSTALLATION TO MEET ENERGY+ REQUIREMENTS. DETERMINATION OF UTILITY METERS OF THIRD PARTY METERING TO BE COMMUNICATED TO ENERGY+.
 - H. ESTIMATED LOAD IS 750KVA. SERVICE IS PLANNED FOR 2000A 208V 3P 4W. DETAILED LOAD ESTIMATES TO BE PREPARED AND SUBMITTED TO BRANDON COLVIN AT ENERGY+.
 - I. DIMENSIONS INDICATE CLOSEST POINTS ON BUILDING TO EXISTING OVERHEAD 240V LINES ON AINSLIE STREET.

1 SITE PLAN
E1
1:150



5		
4		
3		
2		
1	ISSUED FOR SPA	2022.03.22
No	REVISION	DATE

MIGHTON ENGINEERING

300 VICTORIA ST N, 2ND FL PH (519) 745-3703
KITCHENER, ON FAX (519) 745-5081
N2M 6R9 WEB www.mighton.com

PROJECT TITLE:
149 AINSLIE STREET N.
APARTMENT
149 AINSLIE STREET NORTH,
CAMBRIDGE, ONTARIO

DRAWING TITLE:
SITE ELECTRICAL PLAN

DRAWN BY:	MRJ	CUSTOMER PROJECT No.	---
CHECKED BY:	T.A	MIGHTON PROJECT No.	42205
DATE:	MAR 2022	DRAWING No.	E1
SCALE:	AS NOTED		