

# STACKED TOWNS

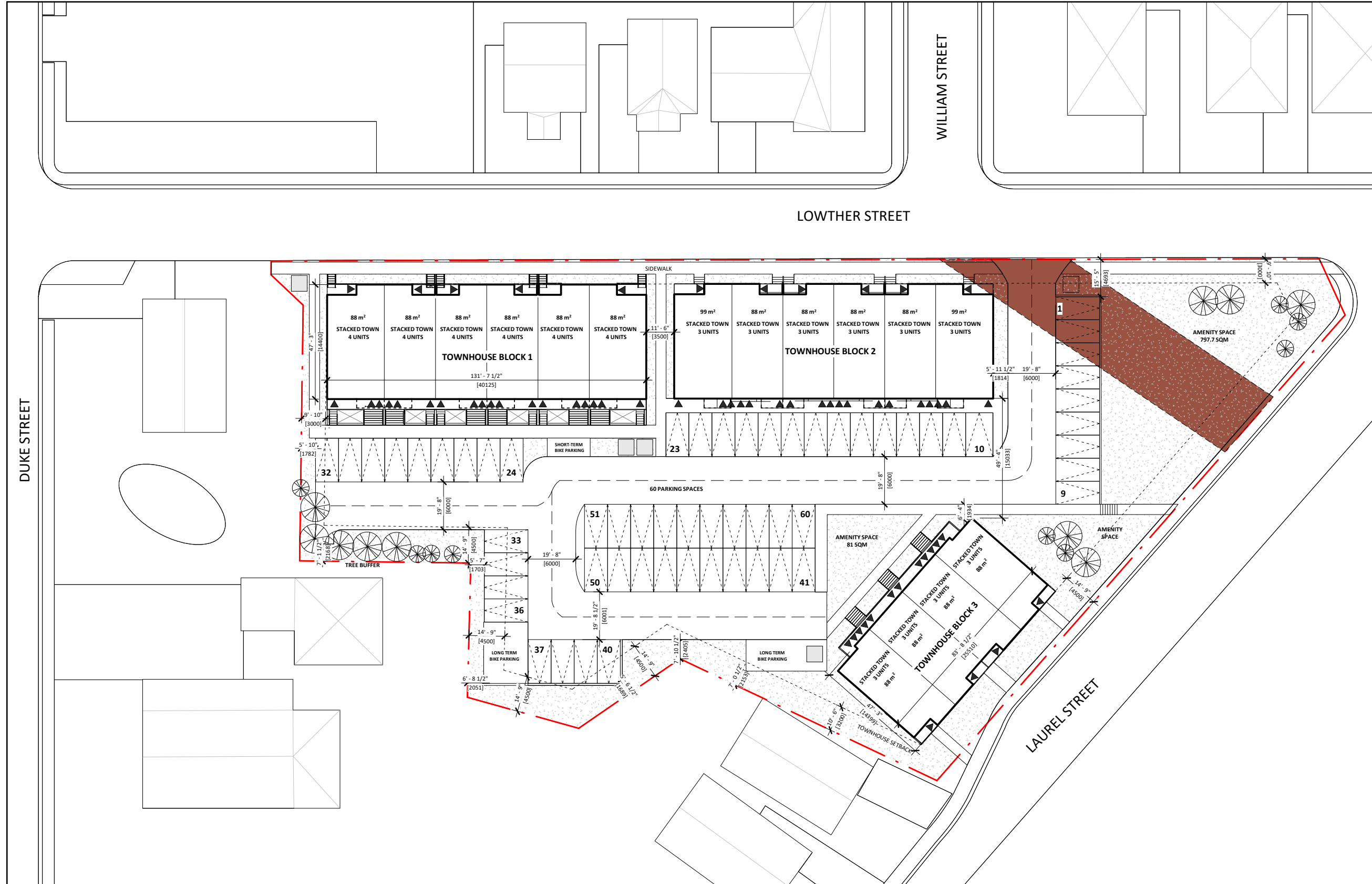

## SITE STATISTICS

Current Zoning - M5  
 Proposed Zoning - RM2  
 Lot Area - 6005.6m<sup>2</sup>  
 Building Coverage - 1718m<sup>2</sup> (28.6%)  
 Landscaped Open Space - 1797m<sup>2</sup> (38%)  
 Hard Surface Area - 2493m<sup>2</sup> (41.5%)  
 Amenity Area - Outdoor: 16.3m<sup>2</sup>/unit  
 Balcony: 4.9m<sup>2</sup>/unit

## STACKED TOWNHOME DEVELOPMENT

Number of Units - 54  
 Gross Floor Area - 4480 m<sup>2</sup>  
 Lot Area - 6005.6m<sup>2</sup>  
 FSI - 0.746

## PARKING

Parking Required -  
 54 resident spaces (1 space/unit)  
 14 visitor spaces (0.25 spaces/unit)  
 Parking Provided -  
 54 resident spaces (1 spaces/unit)  
 6 visitor spaces (.11 spaces/unit)  
 Parking Space Minimum Dimensions -  
 2.9m x 5.5m

## NOTES:

- ALL ASPHALT AREAS TO BE DEFINED WITH 0.15M HIGH POURED CONCRETE CURBING
- PROPOSED WASTE MANAGEMENT STRATEGY IS MUNICIPAL CURBSIDE PICKUP.

## LEGEND:

- Built Area
- Landscaped Area
- Transformers

1 A101 Site - STACKED TOWNS  
 SCALE: 1 : 500