

# MAPLE GROVE ROAD

2-14004 CSP  
N.303.840  
S.303.900

BOXWOOD DRIVE

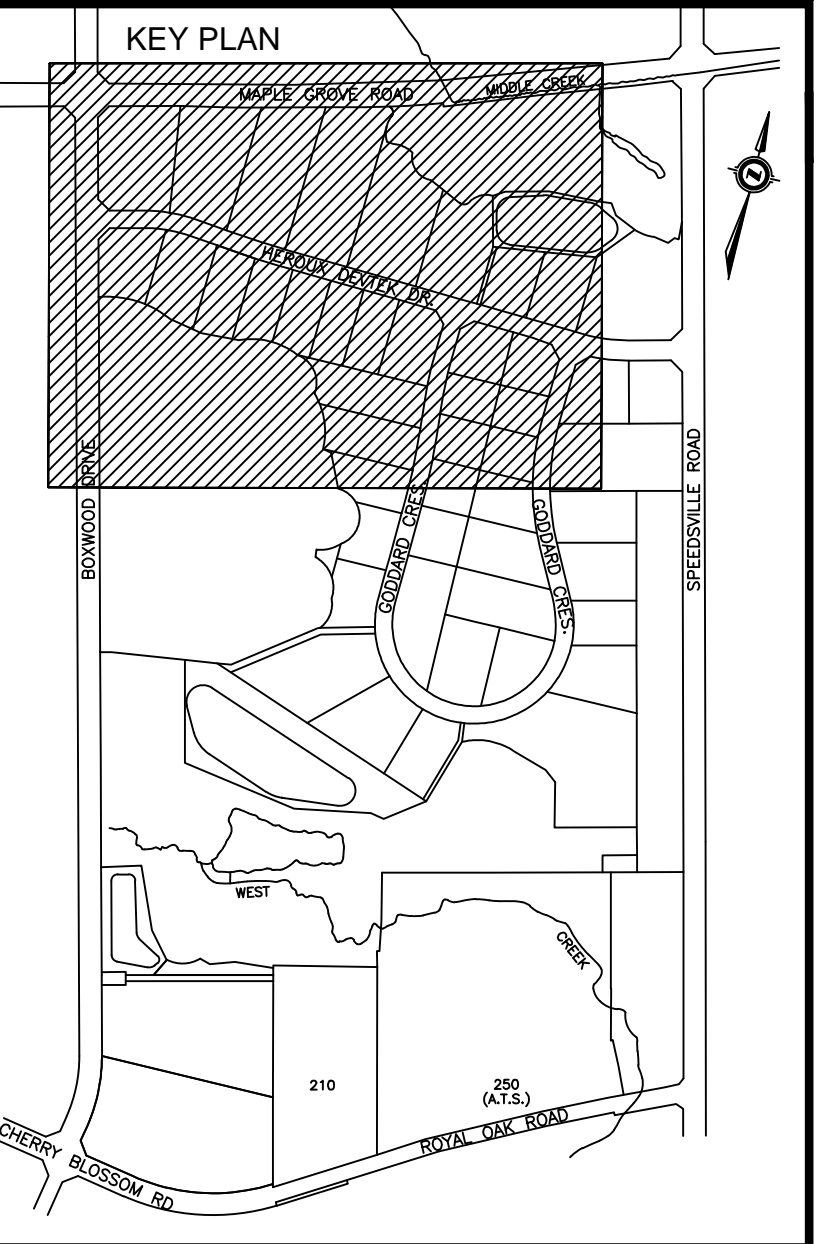

NOTE:  
1. ROUGH GRADING ELEVATIONS AS SUPPLIED BY CONTRACTOR, MAY 2013.

DRAWINGS TO BE READ IN CONJUNCTION WITH GEOTECHNICAL INVESTIGATION PREPARED BY CHUNG & VANDER DOELEN ENGINEERING LTD., FILE NO. 07-07-K20 SUB, DATED FEBRUARY 2, 2011.

THE PARCEL SHOWN ON THIS MAP IS COMPILED FROM VARIOUS SOURCES & IS NOT WARRANTED AS TO ITS ACCURACY BY THE MUNICIPALITY. USERS ARE REMINDED THAT LOT SIZES & LEGAL DESCRIPTIONS MUST BE CONFIRMED AT THE LAND REGISTRY OFFICE. THIS IS NOT A LEGAL DOCUMENT.

THE LOCATIONS OF EXISTING UNDERGROUND UTILITIES ARE SHOWN IN AN APPROXIMATE WAY ONLY AND HAVE NOT BEEN INDEPENDENTLY VERIFIED BY THE OWNER OR THE CITY'S REPRESENTATIVE. THE CONTRACTOR SHALL DETERMINE THE EXACT LOCATION OF ALL EXISTING UTILITIES PRIOR TO CONSTRUCTION AND IS RESPONSIBLE FOR ANY OF ALL DAMAGES WHICH MIGHT OCCUR BY THE CONTRACTOR'S FAILURE TO EXACTLY LOCATE AND PRESERVE ANY AND ALL UNDERGROUND UTILITIES.

NO.	REVISION	BY	DATE
4.	ROUGH GRADING ELEVATIONS ADDED	R.P.	02/19/14
3.	REV. EROSION AND SEDIMENT CONTROL MEASURES	JU	07/16/12
2.	REV. PER GRCA	JU	02/20/12
1.	ISSUED FOR TENDER	KWH	02/21/12

TRUE

STAMP

SURVEY DATA:		DRAWING INFORMATION:	
SURVEY BY:	R.N.	DRAWN BY:	D.M./J.U.
DATE:	DECEMBER 2010	DATE:	JANUARY 2012
FIELD BOOK:		DESIGN BY:	D.M./R.A.
REQUISITION NO:		DATE:	JANUARY 2012
CHECKED BY:		CHECKED BY:	K.H.
DATE:		DATE:	JANUARY 2012



**Delcan** 675 QUEEN STREET S.  
SUITE 201  
KITCHENER, ONTARIO, CANADA  
N2H 2L4  
TEL: (519) 744-4509  
FAX: (519) 744-2822  
WWW.DELCAN.COM

## BOXWOOD SUBDIVISION ROUGH GRADING ELEVATIONS

SCALE: HORIZONTAL: 1:1,000  
DRAWING NO: **GD-01**

