

EQUESTRIAN WAY

SPEEDSVILLE

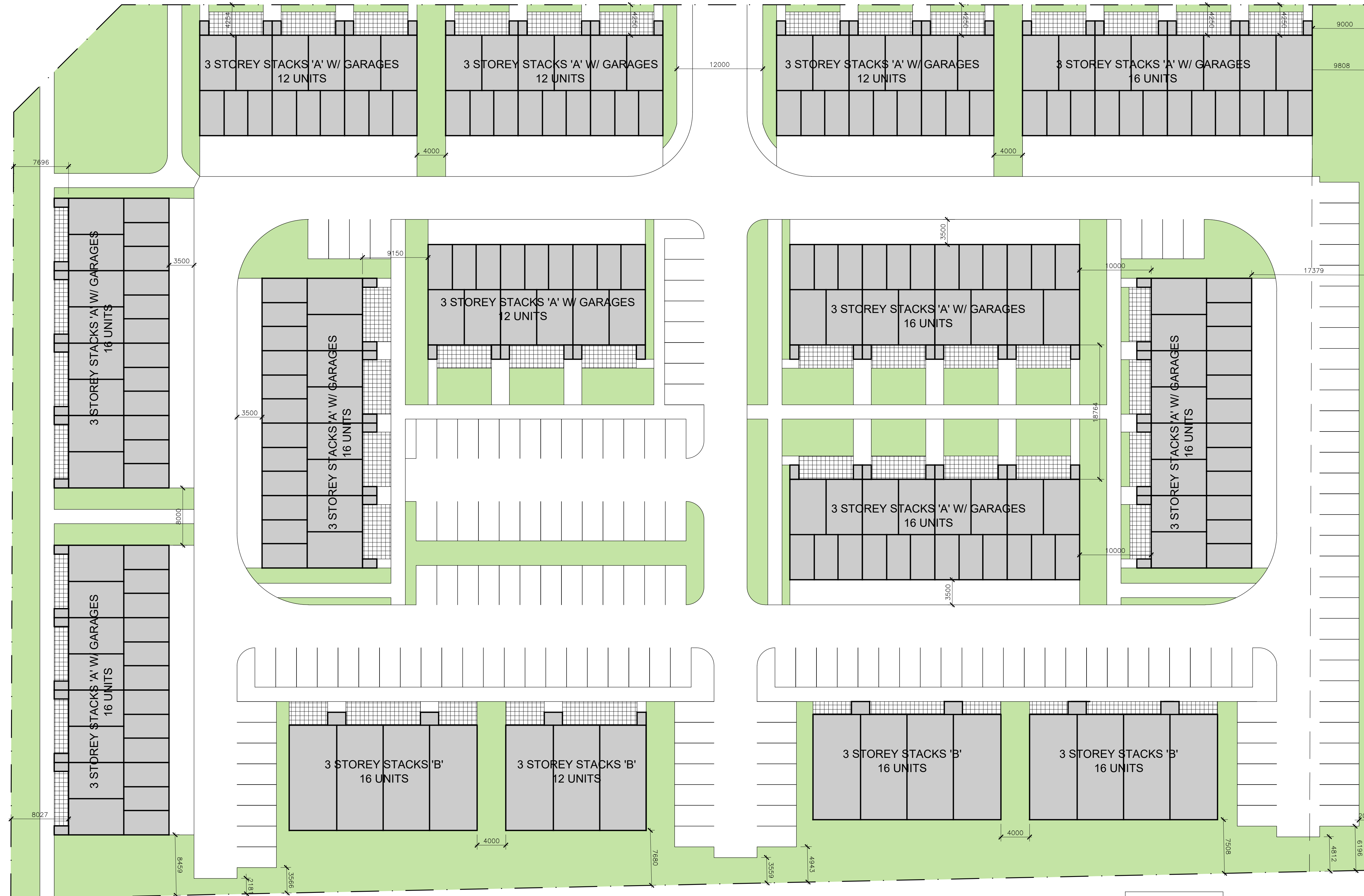

PARKING

1.25 PER UNIT - 275
 120 GARAGES
 155 SURFACE RESIDENTIAL

220 UNITS TOTAL

160 STACKED TOWNS 'A' (W/ 120 GARAGES)
 60 STACKED TOWNS 'B'
 +/-95 uph

STACKS A

3 GARAGE FOR EVERY 4 UNITS
 LOWER UNITS @ +/-1200SF
 UPPER UNITS @ +/-1600SF

STACKS B

LOWER UNITS @ +/-900SF
 UPPER UNITS @ +/-1200SF

CONTRACTOR MUST CHECK AND VERIFY ALL DIMENSIONS AND JOB CONDITIONS BEFORE PROCEEDING WITH WORK. ALL DRAWINGS AND SPECIFICATIONS ARE THE PROPERTY OF THE ARCHITECTS AND MUST BE RETURNED AT THE COMPLETION OF THE WORK.

THE CONTRACTOR WORKING FROM DRAWINGS NOT SPECIFICALLY MARKED "FOR CONSTRUCTION" MUST ASSUME FULL RESPONSIBILITY AND BEAR COSTS FOR ANY CORRECTIONS OR DAMAGES RESULTING FROM HIS OR HER WORK.

KEY TO DETAIL LOCATION
 No. DETAIL NUMBER
 No. DRAWING SHEET NUMBER

BUILDING PERMIT NUMBER:
 NOT FOR CONSTRUCTION WITHOUT PERMIT

PRINTS ISSUED	NO.	DATE (DD,MM,YY)	BY
TO ROB M	-	2013-10-23	WH
FOR PRECONSULTATION	-	2013-11-01	WH

REVISIONS TO DRAWING	NO.	DATE (DD,MM,YY)	BY
NOT FOR CONSTRUCTION			

KNYMH
 ARCHITECTURE • SOLUTIONS

KNYMH INC.
 1006 SKYVIEW DRIVE • SUITE 101
 BURLINGTON, ONTARIO • L7P 0V1
 T 905.639.6595
 F 905.639.0394
 www.knymh.com info@knymh.com

PROJECT NORTH

PRELIMINARY

RIVER MILL
 CAMBRIDGE, ONTARIO

DRAWING SHEET TITLE:
 EQUESTRIAN SOUTH RESIDENTIAL STACKS

DRAWING SCALE:
 AS NOTED

KNY PROJECT NUMBER:
 18047

DRAWN BY:
 WH

CHECKED BY:
 WH

PLOT DATE:
 August 17, 2023

DRAWING SHEET NUMBER:
 SP1